

Vector Turbo Self-Contained Series

Optimized Marine Design



VTD14K Vector Turbo shown with optional Sound Shield

Rust-free molded composite drain pan designed for quick removal of condensate water. Innovatively designed sloped channels route water rapidly to a choice of three easy-to-plumb drain locations.

Experience better noise reduction with a built-in cushion system that minimizes vibration to the deck. Additionally, the innovative mounting clips utilize vibration isolators. As shown in the photo, the optional molded compressor sound shield maximizes noise containment.

The enclosed motor eliminates overhang, and the high-velocity blower can be rotated through 270° with one adjustment screw. The unit's unique inlet ring is designed to optimize air flow and ensure that the height of the unit does not increase when the blower rotates.

Easy-to-install sound covers reduce noise by up to 50%



These compact, easy-to-install sound covers are available for all Vector Turbo models. The cover fits over the compressor, providing a 3- to 5-dB noise reduction—which is about a 50% drop in what the human ear can perceive. Installation takes just minutes and all mounting hardware is included.

Key Benefits

- Up to 85% reduction in standing water in the drain pan.
- Up to 27% reduced amperage.
- Up to 21% increased capacity.
- No blower motor overhang reduces depth.
- Average installation time reduced by 10–20 minutes.
- Compatible with Elite™ and Passport® Controls.
- Up to 50% noise reduction with optional sound cover.

Technical Specifications for Vector Turbo

Model	VTD6K			VTD8K			VTD10K			VTD12K			VTD14K			VTD16K			
	6,000			8,000			10,000			12,000			14,000			16,000			
Capacity (BTU/hr)	115	220-240	115	230	220-240	115	230	220-240	115	230	220-240	115	230	220-240	115	230	220-240		
Voltage (VAC)	60	1	50	1	60	1	60	1	60	1	60	1	60	1	60	1	60	1	
Cycle (Hz)/Phase (Ph)	3.8	2.1	5.4	2.6	3.6	6.0	3.1	3.4	6.8	3.4	3.7	7.8	4.2	4.4	9.4	4.6	4.5		
Full Load Amps (FLA) cool	5.0	2.8	7.0	3.4	4.4	8.3	4.2	4.3	9.4	4.7	4.7	11.3	5.4	5.8	12.4	6.2	5.8		
Full Load Amps (FLA) heat	29	11	40	19	20	42	21	16.9	53	26	22.2	58	33	22	59	34	32		
Locked Rotor Amps (Comp)	0.6	0.7	0.8	0.8	1.1	1.0	1.0	1.0	1.1	1.1	1.1	1.3	1.3	1.4	1.4	1.4	1.4		
K.V.A. (Kilo-Volt-Amps)	15	9	21	10	13	25	14	13	31	15	15	33	18	18	40	21	19		
Max. Circuit Breaker (Amps)	9	5	12	6	8	14	8	8	17	9	8	19	10	10	23	12	11		
Min. Circuit Ampacity (Amps)	8	227	10	283	10	283	10.5	298	10.5	298	11	312	11	312	13	369	13	369	
Refrigerant R-22 (oz/g)	10.8	27.4	10.8	27.4	10.8	27.4	12.2	31.0	12.2	31.0	12.2	31.0	12.2	31.0	12.9	32.8	12.9	32.8	
Unit Dimensions (in/cm)																			
Height – Evaporator (C ¹)	10.8	27.4	10.8	27.4	10.8	27.4	12.2	31.0	12.2	31.0	12.2	31.0	12.2	31.0	12.9	32.8	12.9	32.8	
Height – Compressor (D ¹)	12.2	31.0	12.2	31.0	12.2	31.0	13.0	32.9	13.0	32.9	14.2	36.1	14.2	36.1	14.2	36.1	14.2	36.1	
Height – w/opt. Sound Cover	13.0	33.0	13.0	33.0	13.0	33.0	13.5	34.3	13.5	34.3	15.0	38.1	15.0	38.1	15.0	38.1	15.0	38.1	
Width (A ¹)	17.6	44.7	17.6	44.7	17.6	44.7	20.4	51.8	20.4	51.8	20.4	51.8	20.4	51.8	21.4	54.4	21.4	54.4	
Depth (B ¹)	10.7	27.2	10.7	27.2	10.7	27.2	12.4	31.5	12.4	31.5	12.4	31.5	12.4	31.5	13.3	33.8	13.3	33.8	
Min. Duct Size Dia.	4	10.2	5	12.7	5	12.7	6	15.2	6	15.2	6	15.2	6	15.2	7	17.8	7	17.8	
Min. SA Grill (sq in/cm)	32	206	48	310	48	310	60	387	60	387	70	452	70	452	80	490	80	490	
Min. RA Grill (sq in/cm)	64	413	80	516	80	516	100	710	100	710	130	839	130	839	144	929	144	929	
Net Weight (lbs/kg)	39.6	18.0	40.4	18.3	43.8	19.9	43.6	19.8	43.0	19.5	48.8	22.1	48.8	22.1	52.8	24.0	53.4	24.2	53.4
Gross Weight (lbs/kg)	49.6	22.5	50.4	22.9	53.8	24.4	53.6	24.3	53.0	24.0	58.8	26.7	58.8	26.7	62.8	28.5	63.4	28.8	63.4

Notes:

- 1) Add a 'C' or 'CK' after the capacity designator for 230V or 220-240V/50Hz units respectively. Examples VTD8K = 115V, VTD8CK=230V, VTD8CK=220-240V/50Hz
- 2) BTU and electrical data are based on a 45°F/7.2°C evaporator and 100°F/37.8°C condenser in cool mode, and a 45°F/7.2°C evaporator and 130°F/54.4°C condenser in heat.
- 3) Note: 60Hz units must not operate at 50Hz and 50Hz units must not operate at 60Hz.
- 4) Refrigerant charges shown are for R22. Alternative "Environmentally Friendly Green Gas" refrigerants available on request.
- 5) Electric box is remote mounted up to 34" (86cm) away from compressor. E-box dimensions are 2.7" (6.9cm) x 6.5" (16.5cm) x 8.8" (22.4cm).

† Refers to callouts shown in drawing below.

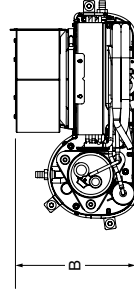

Mounting brackets included
Condensate drain fitting included

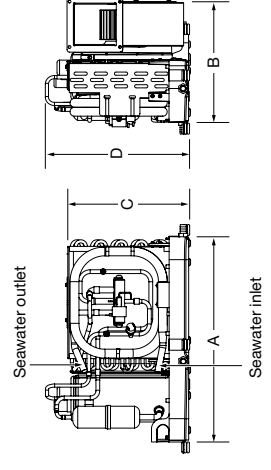

Dealer:

DOMETIC CORPORATION, ENVIRONMENTAL DIVISION

2000 N. Andrews Ave. Ext. I Pompano Beach, FL 33069 USA | 954-973-2477 | Fax 954-979-4414
 P.O. Box 15299 | Richmond, VA 23227 USA | 804-746-1313 | Fax 804-746-7248
www.DometicEnviro.com | sales@DometicEnviro.com

United States & Canada Service Only:

8:00 AM to 5:00 PM Eastern Time | Marine Air AC Products: 954-973-2477
 Cruisair AC Products: 804-746-1313

24/7 AC SERVICE HOTLINE: 5:00PM to 8:00 AM: 888-440-4494

International Sales & Service:

Europe & the Middle East: Call +44(0)870-330-6101

For all other areas visit our website to find your nearest distributor.